

NOTES:

1.0 GENERAL

- 1.1 READ STRUCTURAL DRAWINGS IN CONJUNCTION WITH ALL OTHER CONTRACT DRAWINGS AND DOCUMENTS. REPORT ANY CONFLICTS TO THE ENGINEER BEFORE COMMENCING WORK.
- 1.2 ALL DIMENSIONS ARE APPROXIMATE AND ARE IN MILLIMETRES.
- 1.3 CONTRACTOR'S RESPONSIBILITY: THESE DRAWINGS DEMOLITION OF THE BRIDGE. THE REQUIRED TEMPORARY BRACING AND SHORING TO PERFORM THE WORK SAFELY IS THE RESPONSIBILITY OF THE CONTRACTOR.
- 1.4 ENVIRONMENTAL WORK PROCEDURES, TIMING, AND SPECIAL PRECAUTIONS SHALL BE IN ACCORDANCE WITH THE REQUIREMENTS AND LIMITATIONS OF THE FEDERAL DEPARTMENT OF FISHERIES AND OCEANS, AND THE PROVINCIAL MINISTRY OF WATER, LAND AND AIR PROTECTION.
- 1.5 NO SURVEY HAS BEEN PERFORMED FOR THIS PROJECT.

2.0 DEMOLITION

- 2.1 ALL MATERIAL FROM EXISTING BRIDGE TO BE DISPOSED OF IN ACCORDANCE WITH ALL LOCAL, PROVINCIAL AND FEDERAL REGULATIONS.
- 2.2 DEMOLITION OF EXISTING STRUCTURE TO BE CARRIED OUT IN ACCORDANCE WITH CSA S350, CODE OF PRACTICE FOR SAFETY IN DEMOLITION OF STRUCTURES.

3.0 RIP RAP

3.1 ROCK SHALL BE HARD, DURABLE AND ANGULAR QUARRY ROCK OF A QUALITY THAT WILL NOT DISINTEGRATE ON EXPOSURE TO WATER OR THE ATMOSPHERE. THE GRADATION OF ROCK SIZES SHALL CONFORM TO THE FOLLOWING TABLE:

CLASS OF RIP RAP (KG)	ROCK GRADATION PERCENTAGE SMALLER THAN GIVEN ROCK MASS (KG)		
	15%	50%	85%
250	25	250	750

3.2 THE GRADATION OF ROCKS SHALL BE WELL-GRADED, APPROXIMATELY THE SPECIFIED OR DIRECTED SIZES AND INDIVIDUAL ROCKS MINIMUM DIMENSION SHALL BE GREATER THAN ONE-THIRD ITS MAXIMUM DIMENSION AND NONE SHALL HAVE A MASS GREATER THAN FIVE TIMES THAT OF THE SPECIFIED RIP RAP.

3.3 THE ROCK SHALL BE MANIPULATED AS NECESSARY TO PROVIDE MASS STABILITY AND A REGULAR SURFACE WITH A MINIMUM OF VOIDS.

4.0 ENVIRONMENTAL CONSTRUCTION REQUIREMENTS

- 4.1 SECTION 11 (FILE # 100211582) NOTIFICATION AND DFO APPROVAL REQUIRED.
- 4.2 CONDITIONS OF MELP AND DFO APPROVALS TO BE FOLLOWED.
- 4.3 EROSION AND SEDIMENT CONTROL PLAN TO BE PROVIDED AT PRE-DEMOLITION MEETING AND IN PLACE PRIOR TO DEMOLITION.
- 4.4 DEMOLITION DISTURBANCE TO BE MINIMIZED NEAR OR ADJACENT TO TREED AREAS.
- 4.5 ENVIRONMENTAL MONITOR SHALL BE ENGAGED BY OWNER AND WILL ATTEND SITE PERIODICALLY.
- 4.6 ALL TREES AND ROOTS TO BE PRESERVED WHERE POSSIBLE. ALL DISTURBED AREAS TO BE RESEDED WITH NATIVE GRASS MIX. ANY SHRUBS OR TREES REMOVED MUST BE REPLACED AND THE AREA IS TO BE COVERED IN STRAW MULCH UPON COMPLETION.
- 4.7 IN-STREAM WORK TO OCCUR DURING DRY WEATHER WITHIN FISHERIES WINDOW (JULY 15TH THROUGH SEPTEMBER 15TH).
- 4.8 ALL MACHINERY TO BE CLEAN, FREE OF LEAKS, IN GOOD MECHANICAL CONDITION AND SHALL USE BIODEGRADABLE HYDRAULIC FLUIDS.
- 4.9 REFUELLING OF ALL MACHINES TO BE DONE OUTSIDE OF THE 30 METER SETBACK.
- 4.10 BRIDGE SITE TO BE RESTORED TO A NATURAL RIVER STATE AFTER DEMOLITION.

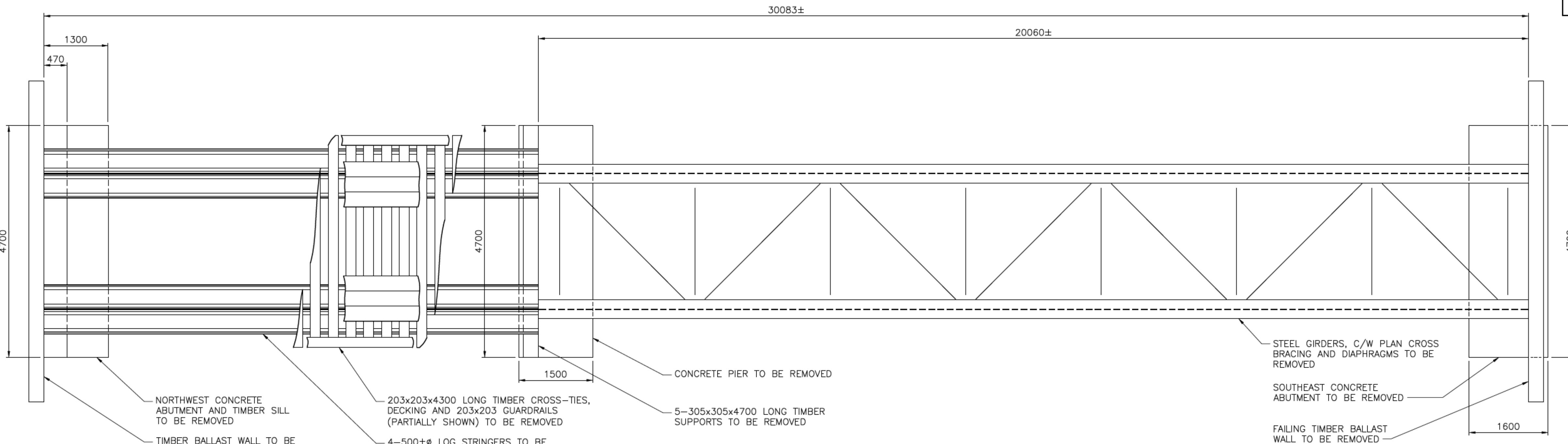
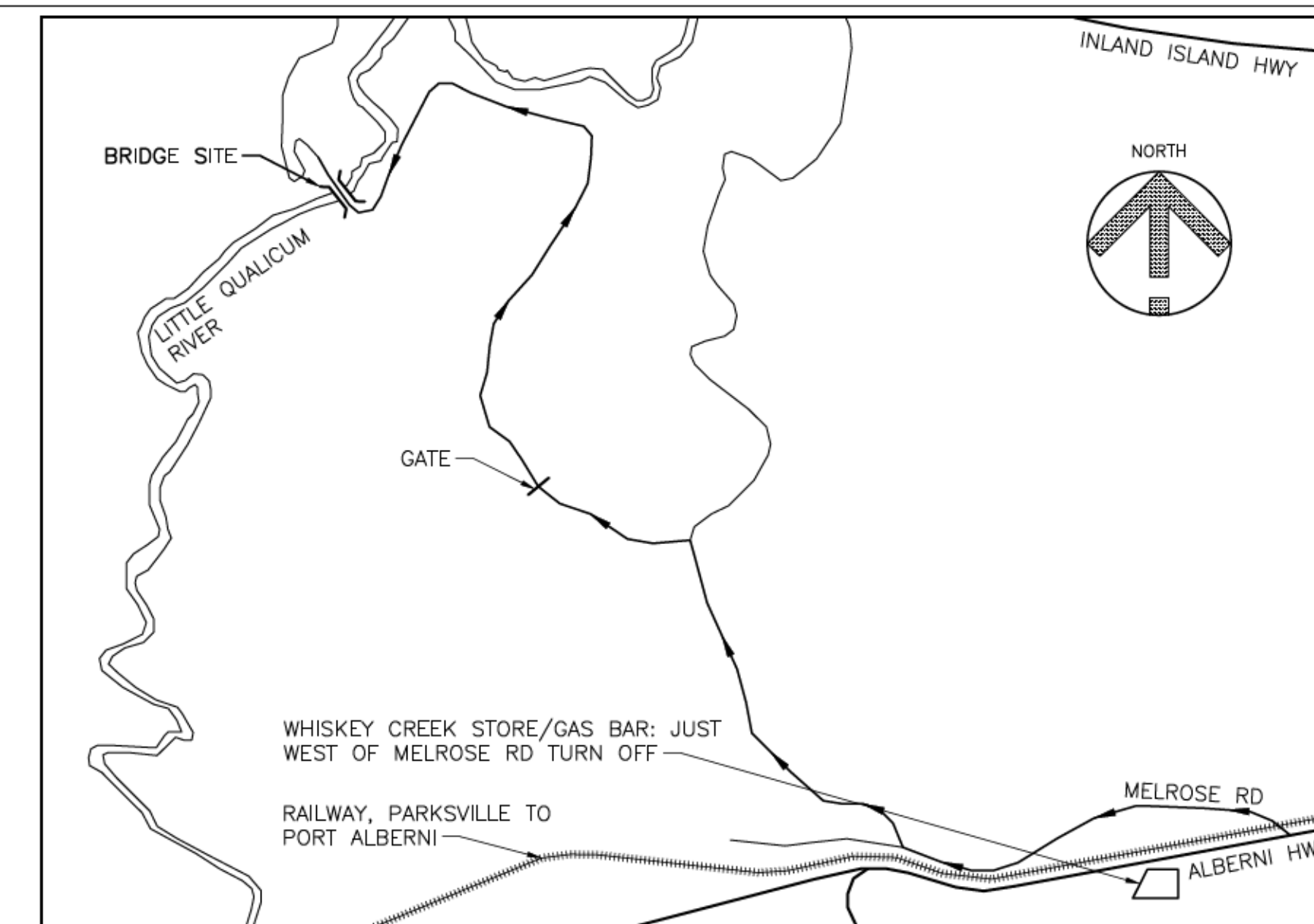

PLAN
1:50

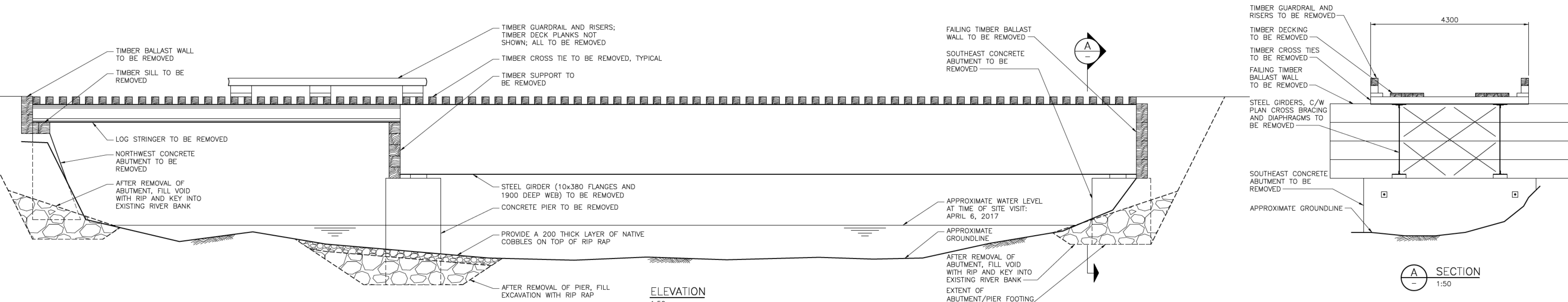

ELEVATION
1:50

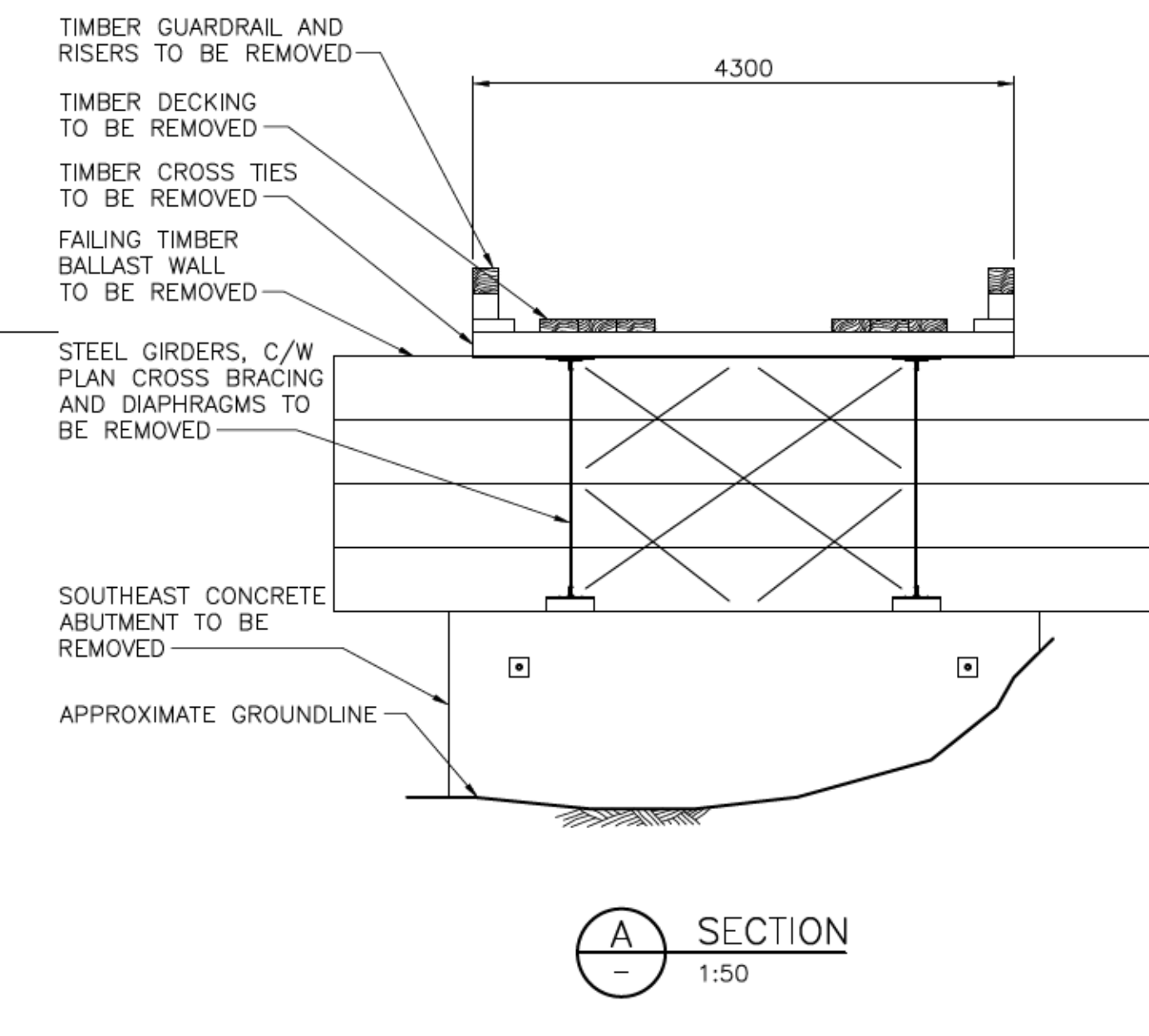

SECTION A-A
1:50

ISSUES					
No.	DATE	ISSUED FOR	No.	DATE	ISSUED FOR
A	2017.07.31	CLIENT REVIEW			
0	2017.08.02	TENDER			

SUB CONSULTANT	

HEROLD ENGINEERING
 3701 Shenton Rd, Nanaimo, BC V9T 2H1
 Tel: 250-751-8558 Fax: 250-751-8559
 Email: mail@heroldengineering.com

ENGINEERS SEAL
DEMOLITION PLAN

LITTLE QUALICUM RIVER PEDESTRIAN BRIDGE
 RECREATION & PARKS PARKSVILLE BC V9P 2X4
 REGIONAL DISTRICT OF NANAIMO

REL PROJECT No. 0837-038	CLIENT DWG. No. N/A
SCALE AS SHOWN	PERMIT No. N/A
REL DRAWING No. S01	REVISION 0

The title block, sheet number, and drawing number are the property of Herold Engineering Limited and may not be reused or reproduced without written consent of Herold Engineering Limited.